

Raccordi filettati in acciaio inossidabile

**Stainless steel
threaded fittings**

**Gewindefittings
aus Edelstahl**

**Raccords filetés
en acier inoxydable**

**Piezas de empalme roscadas
en acero inoxidable**

Listino 1/2025

1/2025 price list - Liste 1/2025

Tarif 1/2025 - Lista 1/2025

ISO 4144

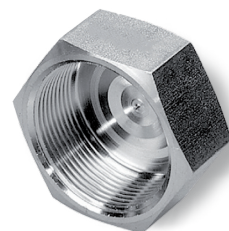

A 30 31

600L/304L

TRONCHETTO DA TUBO SALDATO

- WELDING NIPPLE
- ANSCHWEISSENDE
- DEMI MAMELON
- ENTRONQUE TUBO SOLDADO

MATERIAL: AISI 304L - 1.4307



DIMENSION: ISO 4144

THREAD: EN 10226-1 (ex ISO 7/1)

RATING: 150 PSI - PN10

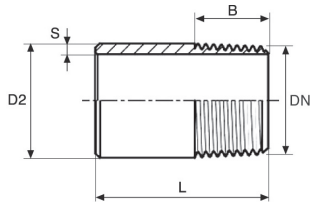
ISO 4144



CODE	DN	DN inch	D2 mm	S mm	L mm	B mm				€
600108304L	6	1/8"	10,3	1,5	18	9	6	10	1200	0,72
600104304L	8	1/4"	13,7	2	20	11	8	10	1000	0,72
600308304L	10	3/8"	17,2	2	20	12	12	10	700	0,81
600102304L	15	1/2"	21,3	2,5	25	14	21	10	400	0,91
600304304L	20	3/4"	26,9	2,5	30	16	32	10	250	1,11
600100304L	25	1"	33,7	3	35	18	58	10	250	1,58
600114304L	32	1 1/4"	42,4	3	35	18	73	5	180	2,03
600112304L	40	1 1/2"	48,3	3	40	21	92	5	120	2,50
600200304L	50	2"	60,3	3,5	45	23	153	5	70	3,80
600212304L	65	2 1/2"	76,1	3,5	45	25	190	1	48	5,07
600300304L	80	3"	88,9	4	50	30	290	1	30	7,48
600400304L	100	4"	114,3	4	60	35	466	1	18	11,11

600L/316L

A 30 31

TRONCHETTO DA TUBO SALDATO

- WELDING NIPPLE
- ANSCHWEISSENDE
- DEMI MAMELON
- ENTRONQUE TUBO SOLDADO

MATERIAL: AISI 316L - 1.4404



DIMENSION: ISO 4144

THREAD: EN 10226-1 (ex ISO 7/1)

RATING: 150 PSI - PN10

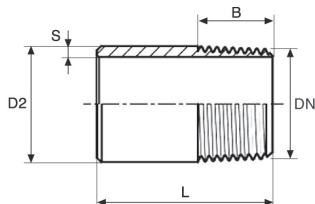
ISO 4144



CODE	DN	DN inch	D2 mm	S mm	L mm	B mm				€
600108316L	6	1/8"	10,3	1,5	18	9	6	10	1200	0,81
600104316L	8	1/4"	13,7	2	20	11	8	10	1000	0,81
600308316L	10	3/8"	17,2	2	20	12	12	10	700	0,91
600102316L	15	1/2"	21,3	2,5	25	14	21	10	400	1,06
600304316L	20	3/4"	26,9	2,5	30	16	32	10	250	1,35
600100316L	25	1"	33,7	3	35	18	58	10	250	1,96
600114316L	32	1 1/4"	42,4	3	35	18	73	5	180	2,50
600112316L	40	1 1/2"	48,3	3	40	21	92	5	120	3,07
600200316L	50	2"	60,3	3,5	45	23	153	5	70	4,71
600212316L	65	2 1/2"	76,1	3,5	45	25	190	1	48	6,40
600300316L	80	3"	88,9	4	50	30	290	1	30	9,32
600400316L	100	4"	114,3	4	60	35	466	1	18	14,02

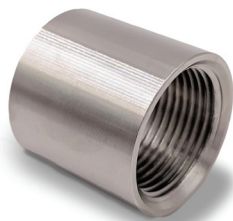
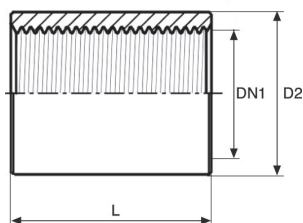

ISO 4144

268L/304L



A 30 31

MANICOTTO

- SOCKET
- MUFFE G.L.
- MANCHON
- MANGUITO

Da tubo S.S.
From seamless pipe

MATERIAL: AISI 304L - 1.4307**DIMENSION:** ISO 4144**THREAD:** EN 10226-1 (ex ISO 7/1)**RATING:** 150 PSI - PN10

CODE	DN	DN1 inch	D2 mm	L mm				€
268108304L	6	1/8"	13,8	18	13	10	1200	1,00
268104304L	8	1/4"	17,8	18	19	10	700	1,06
268308304L	10	3/8"	21,1	20	25	10	500	1,20
268102304L	15	1/2"	25,8	25	43	10	320	1,53
268304304L	20	3/4"	31,3	30	64	10	180	2,03
268100304L	25	1"	38,8	35	108	10	100	3,11
268114304L	32	1 1/4"	47,8	38	157	5	100	4,27
268112304L	40	1 1/2"	53,8	40	187	5	80	5,18
268200304L	50	2"	65	42	212	5	45	6,34
268212304L	65	2 1/2"	80,6	50	340	1	32	11,38
268300304L	80	3"	93,3	50	390	1	20	13,32
268400304L	100	4"	119,3	60	690	1	15	21,04

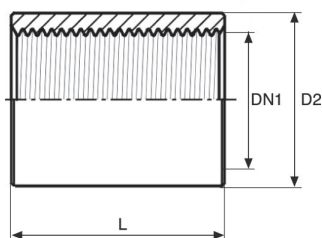

ISO 4144

268L/316L



A 30 31

MANICOTTO

- SOCKET
- MUFFE G.L.
- MANCHON
- MANGUITO

Da tubo S.S.
From seamless pipe

MATERIAL: AISI 316L - 1.4404**DIMENSION:** ISO 4144**THREAD:** EN 10226-1 (ex ISO 7/1)**RATING:** 150 PSI - PN10

CODE	DN	DN1 inch	D2 mm	L mm				€
268108316L	6	1/8"	13,8	18	13	10	1200	1,11
268104316L	8	1/4"	17,8	18	19	10	700	1,20
268308316L	10	3/8"	21,1	20	25	10	500	1,35
268102316L	15	1/2"	25,8	25	43	10	320	1,92
268304316L	20	3/4"	31,3	30	64	10	180	2,50
268100316L	25	1"	38,8	35	108	10	100	3,89
268114316L	32	1 1/4"	47,8	38	157	5	100	5,48
268112316L	40	1 1/2"	53,8	40	187	5	80	6,48
268200316L	50	2"	65	42	212	5	45	8,11
268212316L	65	2 1/2"	80,6	50	340	1	32	14,15
268300316L	80	3"	93,3	50	390	1	20	16,65
268400316L	100	4"	119,3	60	690	1	15	26,47

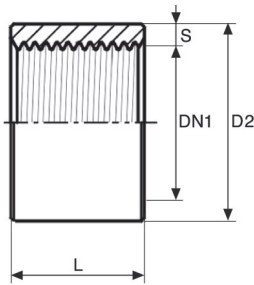
**168L/304L****A 30 31****MEZZO MANICOTTO**

- HALF SOCKET
- MUFFE H.L.
- DEMI MANCHON
- MEDIO MANGUITO

Da tubo S.S.
From seamless pipe

MATERIAL: AISI 304L - 1.4307**DIMENSION:** ISO 4144**THREAD:** EN 10226-1 (ex ISO 7/1)**RATING:** 150 PSI - PN10**ISO 4144**

CODE	DN	DN1 inch	D2 mm	L mm				€
168108304L	6	1/8"	13,8	8	5	10	200	0,91
168104304L	8	1/4"	17,8	11	11	10	1200	0,97
168308304L	10	3/8"	21,1	12	15	10	700	1,08
168102304L	15	1/2"	25,8	15	25	10	400	1,29
168304304L	20	3/4"	31,3	15	31	10	250	1,49
168100304L	25	1"	38,8	18	56	10	160	2,20
168114304L	32	1 1/4"	47,8	20	79	5	100	3,11
168112304L	40	1 1/2"	53,8	20	91	5	150	3,65
168200304L	50	2"	65	25	129	5	80	4,86
168212304L	65	2 1/2"	80,6	25	166	1	50	7,17
168300304L	80	3"	93,3	25	195	1	30	8,67
168400304L	100	4"	119,3	35	400	1	20	14,39

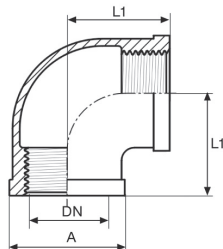
**90L****A 30 31****GOMITO 90° FF**

- ELBOW 90° F/F
- WINKEL 90° I/I
- COUDE FF 90°
- CODO 90 HH

MATERIAL: AISI 316 - 1.4401**DIMENSION:** ISO 4144**THREAD:** EN 10226-1 (ex ISO 7/1)**RATING:** 150 PSI - PN10**ISO 4144**

CODE	DN	DN inch	A mm	L1 mm				€
090108316L	6	1/8"	14,5	17	22	10	900	1,44
090104316L	8	1/4"	18	19	34	10	600	2,08
090308316L	10	3/8"	22	23	54	10	360	2,89
090102316L	15	1/2"	26,5	27	63	10	250	2,45
090304316L	20	3/4"	32	32	96	5	150	3,69
090100316L	25	1"	39,5	38	165	5	100	6,34
090114316L	32	1 1/4"	49	45	256	2	50	9,65
090112316L	40	1 1/2"	55,5	48	356	2	30	13,25
090200316L	50	2"	68,5	57	562	2	20	21,14
090212316L	65	2 1/2"	86	69	922	1	10	39,13
090300316L	80	3"	97,7	78	1383	1	5	59,01
090400316L	100	4"	125	96	2337	1	4	94,75

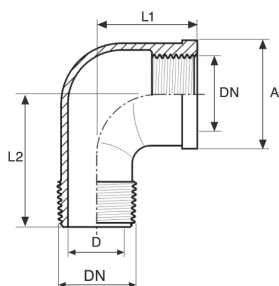

ISO 4144

92L

GOMITO 90° MF

- ELBOW 90° M/F
- WINKEL 90° I/A
- COUDE MF 90°
- CODO 90 MH



MATERIAL: AISI 316 - 1.4401

DIMENSION: ISO 4144

THREAD: EN 10226-1 (ex ISO 7/1)

RATING: 150 PSI - PN10

A 30 31

CODE	DN	DN inch	A mm	L1 mm	L2 mm	D mm				€
092108316L	6	1/8"	14,5	17	26	5,5	17	10	1000	1,20
092104316L	8	1/4"	17,8	19	28	7,6	29	10	700	1,78
092308316L	10	3/8"	21,7	23	30	11	42	10	450	2,41
092102316L	15	1/2"	26,5	27	36	15	57	10	250	2,41
092304316L	20	3/4"	32	32	40	20,5	91	5	150	3,61
092100316L	25	1"	39,5	38	47	26	145	5	100	5,96
092114316L	32	1 1/4"	49	45	55	34,5	236	2	50	9,80
092112316L	40	1 1/2"	55,5	48	57	40	309	2	32	12,69
092200316L	50	2"	68,5	57	70	51	552	2	20	22,14
092212316L	65	2 1/2"	84	69	83	65,5	1078	1	14	44,86
092300316L	80	3"	97	78	94	77,5	1446	1	8	61,61
092400316L	100	4"	123	97	115	101,5	2429	1	4	98,85

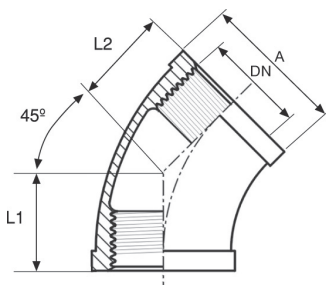

ISO 4144

121L

GOMITO 45° FF

- ELBOW 45° F/F
- WINKEL 45° I/I
- COUDE FF 45°
- CODO 45 HH



MATERIAL: AISI 316 - 1.4401

DIMENSION: ISO 4144

THREAD: EN 10226-1 (ex ISO 7/1)

RATING: 150 PSI - PN10

A 30 31

CODE	DN	DN inch	A mm	L1 mm	L2 mm				€
121108316L	6	1/8"	14,1	16	16	22	10	900	1,49
121104316L	8	1/4"	18	17	17	31	10	650	2,20
121308316L	10	3/8"	20,7	19	19	42	10	450	2,70
121102316L	15	1/2"	26	21	21	56	10	250	2,55
121304316L	20	3/4"	31	25	25	79	5	120	3,54
121100316L	25	1"	38,5	29	29	132	5	100	6,75
121114316L	32	1 1/4"	48	33	33	202	2	36	10,87
121112316L	40	1 1/2"	54,5	37	37	282	2	30	13,52
121200316L	50	2"	67	42	42	444	2	24	21,04
121212316L	65	2 1/2"	84	49	49	613	1	10	36,47
121300316L	80	3"	97	54	54	1050	1	6	51,62
121400316L	100	4"	123	64	64	1806	1	3	90,34

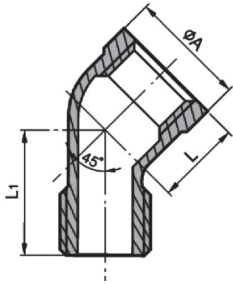

122L

GOMITO 45° MF

- ELBOW 45° M/F
- WINKEL 45° I/A
- COUDE MF 45°
- CODO 45 MH

MATERIAL: AISI 316 - 1.4401



DIMENSION: ISO 4144

THREAD: EN 10226-1 (ex ISO 7/1)

RATING: 150 PSI - PN10

ISO 4144

A 30 31

CODE	DN	DN inch	A mm	L mm	L1 mm				€
122108316L	6	1/8"	16,5	14	24	20	10	900	1,49
122104316L	8	1/4"	18,5	15,5	27	33	10	600	2,20
122308316L	10	3/8"	23,5	18	29	45	10	450	2,70
122102316L	15	1/2"	26	23	32	57	10	220	2,55
122304316L	20	3/4"	31	23,5	35,5	84	5	110	3,54
122100316L	25	1"	41,5	28	42,5	155	5	90	6,75
122114316L	32	1 1/4"	51,5	33	44,5	246	2	32	10,87
122112316L	40	1 1/2"	54,5	35	44,5	309	2	26	13,52
122200316L	50	2"	70	40	58	492	2	22	21,04
122212316L	65	2 1/2"	84	50	70	875	1	8	36,47
122300316L	80	3"	98,5	56	75	1212	1	5	51,62
122400316L	100	4"	125	68	90	2221	1	2	90,34

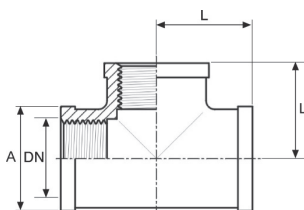

131L

TEE NORMALE

- TEE
- T-STÜCK
- TEE
- TE IGUAL

MATERIAL: AISI 316 - 1.4401



DIMENSION: ISO 4144

THREAD: EN 10226-1 (ex ISO 7/1)

RATING: 150 PSI - PN10

ISO 4144

A 30 31

CODE	DN	DN inch	A mm	L mm				€
131108316L	6	1/8"	14,5	17	31	10	450	2,03
131104316L	8	1/4"	18	19	47	10	400	2,83
131308316L	10	3/8"	21,5	23	71	10	250	3,89
131102316L	15	1/2"	26,5	27	88	10	180	3,40
131304316L	20	3/4"	32	32	129	5	100	5,10
131100316L	25	1"	39,5	38	210	5	60	8,20
131114316L	32	1 1/4"	49	45	336	2	40	12,92
131112316L	40	1 1/2"	55,5	48	445	2	30	16,72
131200316L	50	2"	68,5	57	711	2	18	26,93
131212316L	65	2 1/2"	85	69	1186	1	6	58,44
131300316L	80	3"	99	78	1787	1	5	79,50
131400316L	100	4"	125	96	3030	1	2	127,01

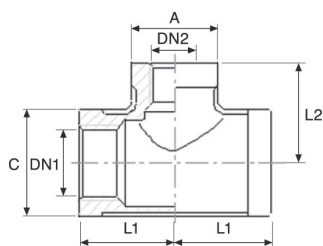

ISO 4144

132L

TEE RIDOTTO

- REDUCING TEE
- T-STÜCK MIT REDUZIERTEM ABGANG
- TEE RÉDUIT
- TE CON SALIDA REDUCIDA

MATERIAL: AISI 316 - 1.4401

DIMENSION: ISO 4144

THREAD: EN 10226-1 (ex ISO 7/1)

RATING: 150 PSI - PN10

CODE	DN1 inch	DN2 inch	A mm	C mm	L1 mm	L2 mm				€
132308104L	3/8"	1/4"	17,2	20,7	20	22	53	10	300	3,07
132102308L	1/2"	3/8"	20,7	25,2	26	25	77	10	180	3,23
132304102L	3/4"	1/2"	25,2	30,7	29	30	120	5	100	5,17
132100102L	1"	1/2"	25,2	38,2	32	33	159	5	60	6,75
132100304L	1"	3/4"	30,7	38,2	34	35	182	5	60	7,67
132114102L	1 1/4"	1/2"	25,2	47,5	34	37	216	2	40	9,68
132114304L	1 1/4"	3/4"	30,7	47,5	38	40	251	2	40	10,45
132114100L	1 1/4"	1"	38,2	47,5	40	42	276	2	40	11,64
132112102L	1 1/2"	1/2"	25,2	54	34	40	261	2	30	12,34
132112304L	1 1/2"	3/4"	30,7	54	37	43	285	2	30	13,42
132112100L	1 1/2"	1"	38,2	54	41	45	351	2	30	14,48
132112114L	1 1/2"	1 1/4"	47,5	54	45	48	391	2	30	16,09
132200304L	2"	3/4"	30,7	66,5	40	49	380	2	18	19,92
132200100L	2"	1"	38,2	66,5	44	51	415	2	18	22,42
132200114L	2"	1 1/4"	47,5	66,5	48	54	538	2	18	23,92
132200112L	2"	1 1/2"	53	66,5	52	55	568	2	18	24,17

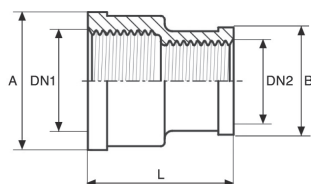

ISO 4144

140L

MANICOTTO RIDOTTO

- REDUCTION SOCKET
- REDUZIERMUFFE
- MANCHON RÉDUIT
- MANGUITO REDUCCIÓN

MATERIAL: AISI 316 - 1.4401

DIMENSION: ISO 4144

THREAD: EN 10226-1 (ex ISO 7/1)

RATING: 150 PSI - PN10

CODE	DN1 inch	DN2 inch	A mm	B mm	L mm				€
140308108L	3/8"	1/8"	21	14	23	20	10	750	1,43
140308104L	3/8"	1/4"	21	17,5	26	26	10	750	1,70
140102308L	1/2"	3/8"	26,5	21,5	34	51	5	400	2,30
140304102L	3/4"	1/2"	32	26,5	36	73	5	270	3,28
140100102L	1"	1/2"	39	25,2	42	110	5	180	4,91
140100304L	1"	3/4"	39,5	32	42	124	5	150	5,12
140114102L	1 1/4"	1/2"	49	26,5	48	154	5	100	6,87
140114304L	1 1/4"	3/4"	49	32	48	163	5	100	7,17
140114100L	1 1/4"	1"	49	39	48	174	5	100	7,88
140112100L	1 1/2"	1"	54	39	52	243	5	75	10,60
140112114L	1 1/2"	1 1/4"	55,5	49	52	292	5	70	10,45
140200100L	2"	1"	68,5	39,5	58	347	5	50	15,02
140200114L	2"	1 1/4"	68,5	49	58	360	5	50	15,20
140200112L	2"	1 1/2"	67,5	54	58	345	5	50	15,57

A 30 31

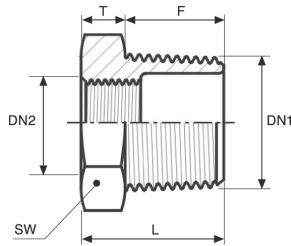

141L

RIDUZIONE MF

- HEXAGONAL BUSHING M/F
- 6-KANT REDUZIERSTÜCK
- REDUCTION MF
- TUERCA REDUCCIÓN



MATERIAL: AISI 316 - 1.4401

DIMENSION: ISO 4144

THREAD: EN 10226-1 (ex ISO 7/1)

RATING: 150 PSI - PN10

ISO 4144

CODE	DN1 inch	DN2 inch	L mm	T mm	F mm	SW mm				€
141104108L	1/4"	1/8"	16	4,5	11,5	14	9	10	1000	0,83
141308108L	3/8"	1/8"	16,5	5	11,5	18	17	10	800	1,43
141308104L	3/8"	1/4"	16,5	5	11,5	18	14	10	800	1,29
141102104L	1/2"	1/4"	20	5,5	14,5	22	23	5	700	1,79
141102308L	1/2"	3/8"	20	5,5	14,5	22	19	5	700	1,58
141304104L	3/4"	1/4"	21	5,5	15,5	27,5	45	5	450	2,87
141304308L	3/4"	3/8"	21	5,5	15,5	27,5	38	5	500	2,93
141304102L	3/4"	1/2"	21	5,5	15,5	27,5	31	5	500	1,58
141100102L	1"	1/2"	24,5	6,5	18	34,5	78	5	250	3,60
141100304L	1"	3/4"	24,5	6,5	18	34,5	54	5	300	2,70
141114102L	1 1/4"	1/2"	27,5	7	20,5	43	139	5	140	6,25
141114304L	1 1/4"	3/4"	27,5	7	20,5	43	95	5	170	5,79
141114100L	1 1/4"	1"	27,5	7	20,5	43	86	5	200	4,26
141112102L	1 1/2"	1/2"	28,5	8	20,5	49	194	5	100	8,35
141112304L	1 1/2"	3/4"	28,5	8	20,5	49	168	5	110	7,59
141112100L	1 1/2"	1"	28,5	8	20,5	49	125	5	130	6,03
141112114L	1 1/2"	1 1/4"	28,5	8	20,5	49	97	5	150	5,03
141200100L	2"	1"	33	8	25	61	266	5	70	11,64
141200114L	2"	1 1/4"	33	8	25	61	290	5	70	11,99
141200112L	2"	1 1/2"	33	8	25	61	250	5	70	10,55
141212100L	2 1/2"	1"	37	10	27	76	840	2	24	18,69
141212114L	2 1/2"	1 1/4"	40	10	30	80,5	723	2	26	19,72
141212112L	2 1/2"	1 1/2"	37	10	27	76	475	2	40	18,02
141212200L	2 1/2"	2"	37	10	27	76	399	2	50	18,34
141300200L	3"	2"	40	10	30	90	532	1	32	24,49
141300212L	3"	2 1/2"	40	10	30	90	469	1	32	26,07
141400200L	4"	2"	46	10	36	115	1545	1	10	63,72
141400212L	4"	2 1/2"	46	10	36	115	926	1	10	45,08
141400300L	4"	3"	46	10	36	115	983	1	10	45,32

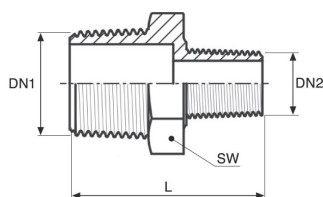

ISO 4144

145L

VITE DOPPIA RIDOTTA



- HEXAGONAL NIPPLE REDUCED
- 6-KANT DOPPELNIPPEL REDUZIERT
- MAMELON RÉDUIT
- MACHÓN REDUCIDO

MATERIAL: AISI 316 - 1.4401

DIMENSION: ISO 4144

THREAD: EN 10226-1 (ex ISO 7/1)

RATING: 150 PSI - PN10

CODE	DN1 inch	DN2 inch	L mm	SW mm				€
145104108L	1/4"	1/8"	22,5	15	13	10	1500	1,13
145308108L	3/8"	1/8"	24	18	26	10	750	2,15
145308104L	3/8"	1/4"	26,5	18	21	10	900	1,79
145102104L	1/2"	1/4"	30	22	32	5	500	2,42
145102308L	1/2"	3/8"	30,5	22	32	5	500	2,55
145304104L	3/4"	1/4"	31,5	28	46	5	300	2,97
145304308L	3/4"	3/8"	32	28	47	5	300	3,07
145304102L	3/4"	1/2"	35,5	28	54	5	300	3,99
145100102L	1"	1/2"	38,5	35	85	5	200	4,20
145100304L	1"	3/4"	39,5	35	89	5	200	4,72
145114102L	1 1/4"	1/2"	41,5	43,5	117	5	120	5,63
145114304L	1 1/4"	3/4"	42,5	43,5	119	5	120	5,75
145114100L	1 1/4"	1"	45	43,5	129	5	120	6,46
145112304L	1 1/2"	3/4"	42,5	49,5	144	5	75	7,32
145112100L	1 1/2"	1"	45	49,5	157	5	75	7,99
145112114L	1 1/2"	1 1/4"	47,5	49,5	169	5	75	8,30
145200100L	2"	1"	50	62	252	5	50	12,14
145200114L	2"	1 1/4"	52,5	62	272	5	50	13,16
145200112L	2"	1 1/2"	52,5	62	296	5	50	15,06
145212100L	2 1/2"	1"	52	77,5	405	2	24	20,13
145212114L	2 1/2"	1 1/4"	54,5	77,5	271	2	24	27,91
145212112L	2 1/2"	1 1/2"	54,5	77,5	435	2	24	21,26
145212200L	2 1/2"	2"	59	77,5	454	2	24	22,39
145300112L	3"	1 1/2"	58	90,5	559	1	20	21,46
145300200L	3"	2"	62,5	90,5	633	1	20	30,84
145300212L	3"	2 1/2"	64,5	90,5	614	1	20	30,79
145400200L	4"	2"	69	116	1133	1	10	66,63
145400212L	4"	2 1/2"	71	116	1044	1	10	61,61
145400300L	4"	3"	74	116	1398	1	10	52,80

A 30 31

180L

CROCE FEMMINA

- CROSS
- KREUZSTÜCK
- CROIX
- CRUZ

MATERIAL: AISI 316 - 1.4401



DIMENSION: ISO 4144

THREAD: EN 10226-1 (ex ISO 7/1)

RATING: 150 PSI - PN10

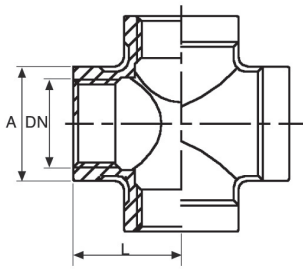
ISO 4144



CODE	DN	DN inch	A mm	L mm				€
180108316L	6	1/8"	13,5	17	35	5	400	2,55
180104316L	8	1/4"	17,5	19	54	5	250	3,47
180308316L	10	3/8"	20,5	23	82	10	120	4,66
180102316L	15	1/2"	26,5	27	100	10	100	4,51
180304316L	20	3/4"	32	32	151	5	50	6,09
180100316L	25	1"	39,5	38	255	5	50	11,15
180114316L	32	1 1/4"	49	45	445	2	30	18,45
180112316L	40	1 1/2"	55,5	48	518	2	18	21,77
180200316L	50	2"	67,3	57	890	2	8	36,15
180212316L	65	2 1/2"	83,5	69	1430	1	6	68,78
180300316L	80	3"	97	78	2006	1	5	90,34
180400316L	100	4"	125	96	3429	1	2	150,63

A 30 31

280L

VITE DOPPIA

- HEXAGON NIPPLE
- 6-KANT DOPPELNIPPEL
- MAMELON DOUBLE
- MACHÓN DOBLE

MATERIAL: AISI 316 - 1.4401



DIMENSION: ISO 4144

THREAD: EN 10226-1 (ex ISO 7/1)

RATING: 150 PSI - PN10

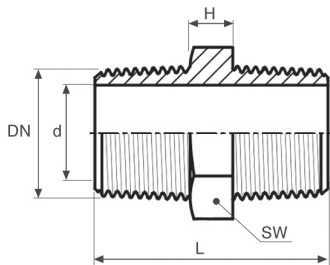
ISO 4144



CODE	DN	DN inch	L mm	H mm	d mm	SW mm				€
280108316L	6	1/8"	20	4	5,5	11	8	10	1500	0,58
280104316L	8	1/4"	25	4	8	15	15	10	1300	1,63
280308316L	10	3/8"	27	5	11,5	18	22	10	900	1,35
280102316L	15	1/2"	34	5	15	22	37	5	250	1,82
280304316L	20	3/4"	36,5	5,5	20,5	28	52	5	150	2,60
280100316L	25	1"	42	6	26	35	96	5	100	4,37
280114316L	32	1 1/4"	47,5	6,5	34,5	43,5	142	5	120	6,67
280112316L	40	1 1/2"	47,5	6,5	40	49,5	169	5	75	8,25
280200316L	50	2"	57	7	51	62	287	5	50	14,01
280212316L	65	2 1/2"	61	7	65,5	77,5	443	2	24	22,74
280300316L	80	3"	67,5	7,5	77,5	90,5	627	1	20	31,96
280400316L	100	4"	80	8	101,5	117	1043	1	10	57,41

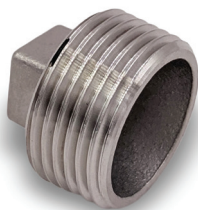
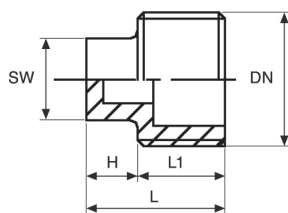

ISO 4144

291L

TAPPO MASCHIO TESTA QUADRA



- SQUARE PLUG
- 4-KANT STOPFEN
- BOUCHON M. CARRÉ
- TAPÓN MACHO CUADRADA

MATERIAL: AISI 316 - 1.4401

DIMENSION: ISO 4144

THREAD: EN 10226-1 (ex ISO 7/1)

RATING: 150 PSI - PN10

CODE	DN	DN inch	L mm	L1 mm	H mm	SW mm				€
291108316L	6	1/8"	11	6	5	6	4	10	2000	0,35
291104316L	8	1/4"	13,5	8,5	5	7	6	10	2000	0,46
291308316L	10	3/8"	15	9	6	8	7	10	1500	0,57
291102316L	15	1/2"	18,5	11,5	7	10	13	5	1000	0,61
291304316L	20	3/4"	21	13	8	12	18	5	600	0,97
291100316L	25	1"	25,5	14,5	11	14	33	5	360	1,75
291114316L	32	1 1/4"	28	17	11	16	80	5	200	2,66
291112316L	40	1 1/2"	29	17	12	20	66	5	150	3,42
291200316L	50	2"	34,5	21,5	13	22	121	5	100	5,98
291212316L	65	2 1/2"	38,5	23,5	15	28	270	2	48	12,71
291300316L	80	3"	41,5	26,5	15	32	393	1	32	18,95

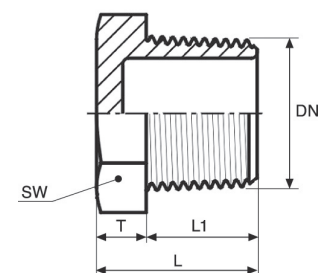

ISO 4144

292L

TAPPO MASCHIO TESTA ESAGONALE



- HEXAGONAL PLUG
- 6-KANT STOPFEN
- BOUCHON M. HEXAGONAL
- TAPÓN MACHO HEXAGONAL

MATERIAL: AISI 316 - 1.4401

DIMENSION: ISO 4144

THREAD: EN 10226-1 (ex ISO 7/1)

RATING: 150 PSI - PN10

CODE	DN	DN inch	L mm	L1 mm	T mm	SW mm				€
292108316L	6	1/8"	12	8	4	11	4	10	2000	0,35
292104316L	8	1/4"	14,5	10,5	4	15	9	10	1500	0,61
292308316L	10	3/8"	16	11	5	18	13	10	1000	0,83
292102316L	15	1/2"	19,5	14,5	5	22	21	5	250	0,97
292304316L	20	3/4"	21	15,5	5,5	28	32	5	150	1,53
292100316L	25	1"	24	18	6	35	55	5	100	2,70
292114316L	32	1 1/4"	27	20,5	6,5	43,5	83	5	130	3,78
292112316L	40	1 1/2"	27	20,5	6,5	49,5	105	5	120	4,91
292200316L	50	2"	32	25	7	62	189	5	80	8,77
292212316L	65	2 1/2"	34	27	7	77,5	396	2	30	16,75
292300316L	80	3"	37,5	30	7,5	90,5	571	1	35	24,08
292400316L	100	4"	44	36	8	117	1059	1	18	44,76

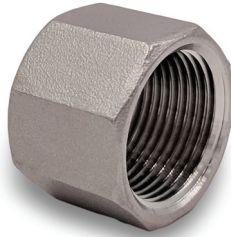
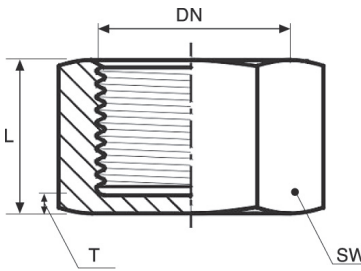



ISO 4144

300L**A 30 31****CALOTTA ESAGONALE**

- HEXAGONAL CAP
- 6-KANT KAPPE
- BOUCHON FEMELLE HEXAGONALE
- TAPÓN HEMBRA HEXAGONAL

MATERIAL: AISI 316 - 1.4401**DIMENSION:** ISO 4144**THREAD:** EN 10226-1 (ex ISO 7/1)**RATING:** 150 PSI - PN10

CODE	DN	DN inch	L mm	T mm	SW mm				€
300108316L	6	1/8"	13,5	1,5	13,5	11	10	1500	0,78
300104316L	8	1/4"	17	1,5	17	16	10	1000	1,18
300308316L	10	3/8"	17,5	1,5	20,5	22	10	600	1,18
300102316L	15	1/2"	21	1,7	25	38	5	400	1,90
300304316L	20	3/4"	22,5	1,7	31	60	5	300	2,55
300100316L	25	1"	26	2	38	82	5	200	4,11
300114316L	32	1 1/4"	29	2,3	47	131	5	150	6,56
300112316L	40	1 1/2"	29	2,5	53	185	5	100	7,84
300200316L	50	2"	33,5	3	66	317	5	60	13,01
300212316L	65	2 1/2"	38,5	3,5	82	480	2	24	21,56
300300316L	80	3"	42	3,8	95,5	753	1	18	33,79
300400316L	100	4"	48,5	4,4	121,5	1347	1	10	57,26

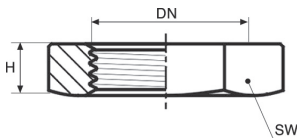



ISO 4144

310L**A 30 31****CONTRODADO**

- BACK NUT
- 6-KANT GEGENMUTTER
- CONTRE ECROU
- CONTRATUERCA

MATERIAL: AISI 316 - 1.4401**DIMENSION:** ISO 4144**THREAD:** ISO 228/1 (ex DIN 259)**RATING:** 150 PSI - PN10

CODE	DN	DN inch	H mm	SW mm				€
310108316L	6	1/8"	5	15	5	10	2000	0,46
310104316L	8	1/4"	6	18	7	10	2000	0,51
310308316L	10	3/8"	6	22	10	10	2000	0,57
310102316L	15	1/2"	7	27	16	5	1000	0,67
310304316L	20	3/4"	7	32	17	5	500	0,78
310100316L	25	1"	9	40	34	5	400	1,53
310114316L	32	1 1/4"	11	48	49	5	300	2,20
310112316L	40	1 1/2"	11	55	63	5	300	3,02
310200316L	50	2"	13	68	110	5	150	5,03
310212316L	65	2 1/2"	15	85	173	2	100	10,20
310300316L	80	3"	17	100	280	1	50	13,42
310400316L	100	4"	20	125	438	1	20	19,97

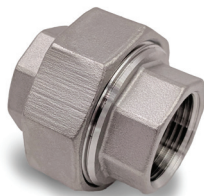
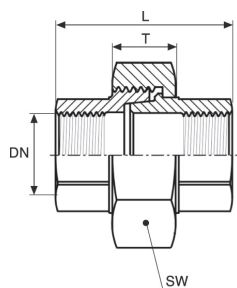

ISO 4144

330L

A 30 31

GIUNTO A 3 PEZZI FF

- UNION CONICAL F/F
- VERSCHRAUBUNG I/I
- MANCHON UNION FF CONIQUE
- ENLACE 3 PIEZAS CÓNICA

MATERIAL: AISI 316 - 1.4401

DIMENSION: ISO 4144

THREAD: EN 10226-1 (ex ISO 7/1)

RATING: 150 PSI - PN10

CODE	DN	DN inch	L mm	T mm	SW mm				€
330108316L	6	1/8"	26	13	25	42	10	220	4,34
330104316L	8	1/4"	31,5	13,5	30,5	79	10	200	5,43
330308316L	10	3/8"	36,5	15,5	34	101	5	200	6,75
330102316L	15	1/2"	39,5	16,5	37	134	5	150	6,70
330304316L	20	3/4"	42,5	18	46	200	5	100	10,35
330100316L	25	1"	49	19	52	269	5	75	13,28
330114316L	32	1"1/4	54	22	65	440	2	44	22,18
330112316L	40	1"1/2	58	24	70	491	2	40	25,40
330200316L	50	2"	65	26	86	832	2	24	40,14
330212316L	65	2"1/2	75	30	105	1240	1	10	64,48
330300316L	80	3"	80,5	31	118	1640	1	10	86,86
330400316L	100	4"	96	34	144	2640	1	4	116,99

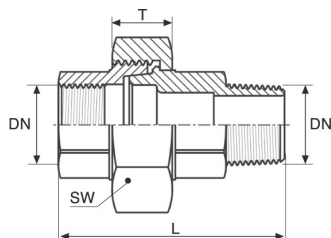

ISO 4144

341L

A 30 31

GIUNTO A 3 PEZZI MF

- UNION CONICAL M/F
- VERSCHRAUBUNG I/A
- MANCHON UNION MF
- ENLACE 3 PIEZAS MH CÓNICA

MATERIAL: AISI 316 - 1.4401

DIMENSION: ISO 4144

THREAD: EN 10226-1 (ex ISO 7/1)

RATING: 150 PSI - PN10

CODE	DN	DN inch	L mm	T mm	SW mm				€
341108316L	6	1/8"	35	13	25	59	5	220	4,34
341104316L	8	1/4"	44	13,5	30,5	104	5	190	5,84
341308316L	10	3/8"	47,5	15,5	34	134	5	150	7,22
341102316L	15	1/2"	54	16,5	37	168	5	115	7,88
341304316L	20	3/4"	58	18	46	255	5	60	11,27
341100316L	25	1"	68	19	52	321	5	60	15,15
341114316L	32	1"1/4	74,5	22	65	518	2	30	23,36
341112316L	40	1"1/2	78,5	24	70	634	2	20	29,66
341200316L	50	2"	90	26	86	966	2	16	44,66
341212316L	65	2"1/2	96	30	105	1580	1	10	72,33
341300316L	80	3"	108	31	118	2080	1	5	91,78
341400316L	100	4"	120	34	144	3040	1	2	132,70

A 30 31

344L

PORTAGOMMA M

- HOSE NIPPLE
- SCHLAUCHNIPPEL
- TETON M
- ENTRONQUE MANGUERA

MATERIAL: AISI 316 - 1.4401



DIMENSION: ISO 4144

THREAD: EN 10226-1 (ex ISO 7/1)

RATING: 150 PSI - PN10

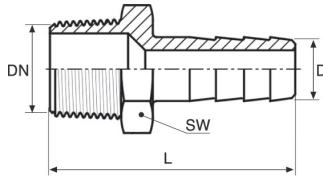
ISO 4144



CODE	DN	DN inch	D mm	L mm	SW mm				€
344108316L	6	1/8"	8	38	11	11	10	1000	1,13
344104316L	8	1/4"	9	42,5	15	18	10	800	1,58
344308316L	10	3/8"	11,5	49	18	28	10	500	2,20
344102316L	15	1/2"	15	57,5	22	53	10	350	2,61
344304316L	20	3/4"	20	66	28	75	5	250	4,05
344100316L	25	1"	27	76	35	139	5	140	6,75
344114316L	32	1 1/4"	33	79	43,5	175	2	100	11,11
344112316L	40	1 1/2"	39,5	83	49,5	200	2	50	11,73
344200316L	50	2"	52	92	62	331	2	24	21,30

FOCUS ON

INFORMAZIONI TECNICHE

Technical info

I raccordi filettati INOX sono usati per tipici impianti di trasporto acqua, aria, gas, olio e vapore.

La "Classe" di prodotto dei raccordi inox è 150 psi.

Il range di temperatura di utilizzo è -20 / +200 °C, mentre la pressione di esercizio è dipendente dalla temperatura secondo tabella seguente (dati ricavati dagli standards ISO 4144 e ANSI/MSS SP-114)

Threaded fittings are used for typical plants to transport water, air, gas, oil and steam.

The "class" product of stainless steel fittings is 150 psi.

The range of operating temperature is -20 / + 200 °C while the pressure depend from temperature in according to the following table (data obtained from the standards ISO 4144 and ANSI / MSS SP-114).

T (C°)		P (bar)
Min	MAX	
-20	40	20
40	100	16,5
100	120	15
120	150	12
150	200	10

ACCOPIAMENTO A TENUTA SUL FILETTO

Norma EN 10226-1 (ex ISO 7/1)

Filettatura gas:

maschio conico [designazione R]**femmina cilindrica [designazione Rp]****COUPLING WITH SEAL ON THE THREAD**

EN 10226-1 (ex ISO 7/1) standard

Gas thread:

conical male [designation R]**cylindrical female [designation Rp]****ACCOPIAMENTO CON GUARNIZIONE PIATTA
(NON A TENUTA SUL FILETTO)**

Norma ISO 228

Filettatura gas:

maschio cilindrico [designazione G (A o B)]**A o B = classi di tolleranza]****femmina cilindrica [designazione G]****COUPLING WITH FLAT GASKET
(NOT HOLDING THE THREAD)**

ISO 228 standard

Gas thread:

cylindrical male [designation G (A or B)]**A or B = tolerance classes]****cylindrical female [designation G]**

This image shows a full page of blank white paper with horizontal ruling lines. The lines are evenly spaced and run across the width of the page, providing a template for writing or drawing. There are no margins, text, or other markings present.

Raccorderie Metalliche S.p.a.

Struttura commerciale Italia Sales Organization



RESPONSABILE VENDITE ITALIA

Massimiliano GABBI

Tel. 0376 960206

Fax 0376 96422

Cell. 335 7663876

massimiliano.gabbi@racmet.com

FUNZIONARI DIRETTI RM

LOMBARDIA

Carlo PUGNAGHI – Funzionario Vendite

Tel. 0376 96001 – Fax 0376 96422

Cell. 335 7364515

carlo.pugnaghi@racmet.com

Matteo VISSER – Funzionario Vendite

Tel. 0376 96001 – Fax 0376 96422

Cell. 335 6907418

matteo.visser@racmet.com

TRIVENETO – MANTOVA

Paolo MEGARESE – Funzionario Vendite

Tel. 0376 96001 – Fax 0376 96422

Cell. 345 5669878

paolo.megarese@racmet.com

Michele MELLINI – Funzionario Vendite

Tel. 0376 96001 – Fax 0376 96422

Cell. 340 6064509

michele.mellini@racmet.com

EMILIA ROMAGNA – MARCHE (PU – AN)

Daniele BONACINI – Funzionario Vendite

Tel. 0376 96001 – Fax 0376 96422

Cell. 344 1174021

daniele.bonacini@racmet.com

TOSCANA

Alessio PAOLESCHI – Funzionario Vendite

Tel. 0376 96001 – Fax 0376 96422

Cell. 335 5251961

alessio.paoleschi@racmet.com

LIGURIA – PIEMONTE – VALLE D'AOSTA

Energy Team di Emerigo Francesco

Via Verdi, 20/D

18100 Imperia (IM)

Tel. 0183 279239 – Fax 0183 653445

info@energyteamliguria.it

Francesco EMERIGO

Cell. 335 5729143

emerigo@energyteamliguria.it

Andrea SPEDICATI

Cell. 347 6039291

spedicati.a@gmail.com

LAZIO

RTL snc di Maramao e C.

Via Morolense, 27

03013 Ferentino (FR)

Tel. 0775 392043

info@rtletis.it

CALABRIA

Agenzia Logozzo Fausto

Via Napoli, 33 – 89042

Gioiosa Ionica (RC)

Cell. 393 9761850

info@agenziaalozzo.com



CAMPANIA

Corrado Rappresentanze sas

Via D. Fontana, 184 – 80131 Napoli (NA)

Tel. 081 5463752 – Fax 081 5464837

Salvatore CORRADO

Cell. 335 6656224

corradosas@fastwebnet.it

ABRUZZO – MOLISE – UMBRIA

MARCHE (AP – FM – MC)

SCR sas di Simoncini O. & C.

Via XXV Aprile 15/8 – 64015 Nereto (TE)

Tel. 0861 851807 – Fax 0861 1856461

Otello SIMONCINI

Cell. 348 3859388

agenziasimoncini@gmail.com

PUGLIA – BASILICATA

F.A.R.P. srl

Viale Vittorio Emanuele II, 26

70010 Cellamare (BA)

Tel. 080 4657523 – Fax 080 4657498

agidue.alloggio@gmail.com

SICILIA OCCIDENTALE PA – TP – AG – CL

Spitaleri Rappresentanze di Spitaleri

Gaetano & C. snc

Via degli Ioni, 7 – 91100 Trapani (TP)

Tel. 0923 567361 – Fax 0923 553588

Gaetano SPITALERI

Cell. 335 5389203

info@spitalerirappresentanze.it

SICILIA ORIENTALE ME – CT – SR – RG – EN

Matteo ARDIZZONE

Via Salvatore Quasimodo, 8

95030 S. Agata Li Battiati (CT)

Tel. 095 213911 – Fax 095 213911

Cell. 337 888806

ardizzone@videobank.it

Nello Fabrizio SCIMONE

Cell. 340 8911730

nf.scimone@gmail.com

SARDEGNA

Marco SECCI

Via Torricelli, 9 – 09047 Selargius (CA)

Tel. 070 3320991 – Fax 1782746902

Cell. 348 6027354

agenzia.mgr@gmail.com

Marine Division

Alessio PAOLESCHI

SALES MANAGER MARINE DIVISION

Cell. +39 335 5251961

alessio.paoleschi@racmet.com



TECHNICAL & SALES CONSULTANT

Matteo AVANZI

Tel. 0376 96001 – Fax 0376 96422

Cell. 342 8068177

tecnico@racmet.com



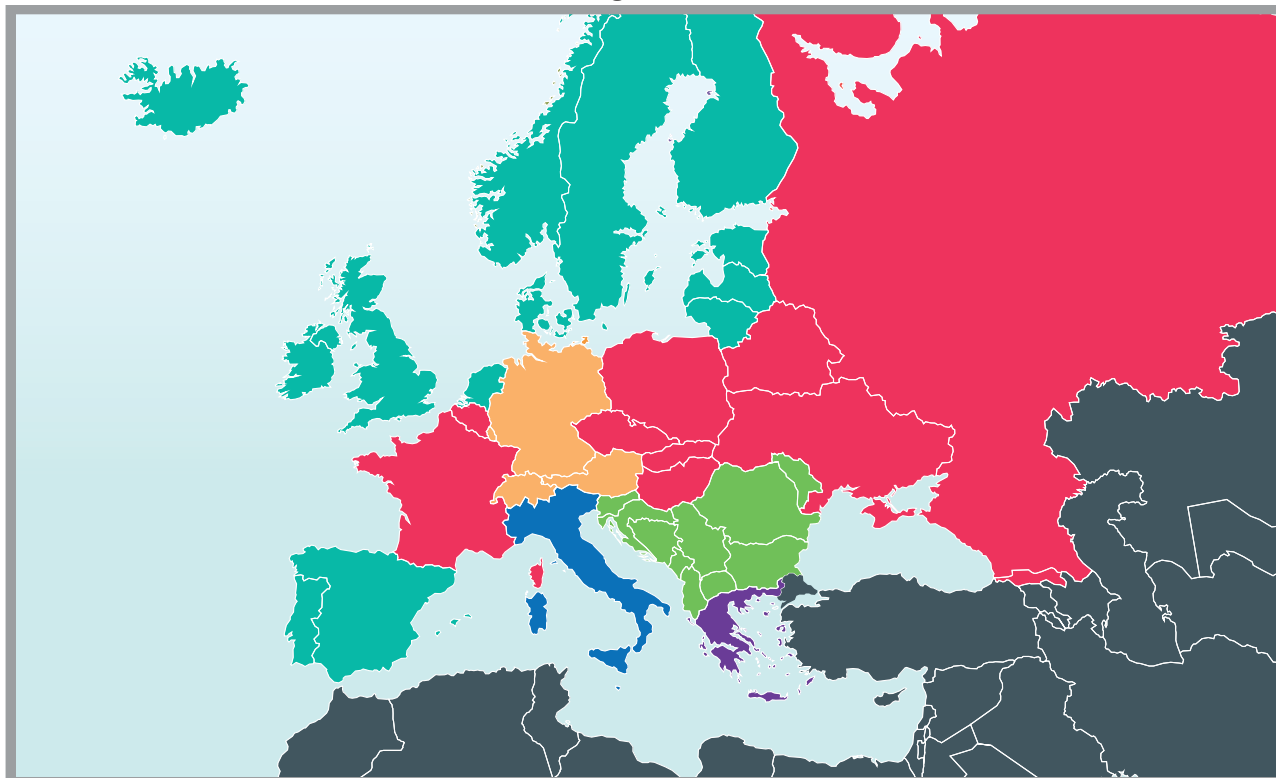

RM Sales Team

Germany - Austria Switzerland - Luxembourg

Francesco GUANZINI

Tel. +39 0376 960285
 Mob. +39 335 7371662
francesco.guanzini@racmet.com

Greece

Massimiliano GABBI

Tel. +39 0376 96 02 06
 Mob. +39 335 7663876
massimiliano.gabbi@racmet.com

Denmark - Finland - Norway Sweden - Estonia - Latvia Lithuania - Iceland Great Britain - Ireland - Spain Portugal - Netherlands

Paolo IMPERIALE

Tel. +39 0376 960259
 Mob. +39 344 0958857
paolo.imperiale@racmet.com

France - Poland - Russia Ukraine - Belarus Czech Republic Slovak Republic Hungary - Belgium

Roberto PEREZ

Tel. +39 0376 960122
 Mob. +39 344 0961187
roberto.perez@racmet.com

RACCORDERIE METALLICHE FRANCE

Frédéric DEVAUX

Tel. +33 4 78 67 54 46
 Mob. +33 698565339
frederic.devaux@racmet.com

Sales Partners

DEUTSCHLAND

Horst HAGEBOEKE

Linden Str., 41
 D-32312 Lübbecke
 Tel. +49 (0) 5741 370180
 Fax +49 (0) 5741 370182
 Mob. +49 (0) 170 204 2100
industrie@hageboeke.com

ROMANIA - BULGARIA SLOVENIA - CROATIA MACEDONIA - ALBANIA MONTENEGRO BOSNIA ERZEGOVINA SERBIA-MOLDOVA KOSOVO

Dejan UGRINIC

Hrvatska - 10431 Sveta
 Nedjelja
 Novaki, Rakitska 25
 Mob. +385 (0) 98 282 405
ugrineks@ugrineks.hr

CZECH & SLOVAKIA REPUBLIC

Samuele PEDRIALI

Mob. +420 736 540 017
samuele.p@atlas.cz

Technický poradce

Radim OBERHERR
 Mob. +420 777 049 805

GREECE

VADIA GIANNOPOULOS ENTERPRISES S.A.

Varis-Koropiou 40-42, Ave
 16672 Vari-Athens
 Tel. +30 210 9654006
 Fax +30 210 9654666
info@bgiannopoulos.gr

POLAND

Robert WRÓBLEWSKI

Tel. +48 603 093 881
robert.wroblewskirm@gmail.com

HUNGARY

György KOVÁCS

Mob. +36 20 432 4732
gyorgy.kovacs@racmet.com

Extra EU Countries

Sandro CARIOTTI

SALES MANAGER EXTRA EU
 Mob. +39 342 6310071
sandro.cariotti@racmet.com

Akash YADAV

COUNTRY MANAGER - INDIA
 Mob. +91 9910921430
akash.yadav@racmet.com

Marine Division

Alessio PAOLESCHI

SALES MANAGER MARINE DIVISION
 Mob. +39 335 5251961
alessio.paoleschi@racmet.com





RACORDERIE METALLICHE

RACORDERIE METALLICHE S.p.A.

Head Office and Manufacturing Plant:

Strada Sabbionetana, 59

46010 Campitello di Marcaria (MN) ITALY

Tel. +39 0376 96001

info@racmet.com

racorderiemetalliche.com

CODE 155 R0 0125 PLU